

INSTALLATION DATA

HYPRES™ DIE SETS AND (# OF CRIMPS EACH END)

REV.	DATE	DESCRIPTION	ECO	BY	C'K'D.
D	1/23/2014	DRAWING RELEASED	34472	GN	MB

CATALOG NUMBER	CONDUCTORS		STR.	O.D.	B	L	TOOL INDEX NO.	HYPRES™ DIE SETS AND (# OF CRIMPS EACH END)						KEARNEY DIE	
	ALUMINUM CABLE							Y34A	Y35/Y750	Y45	Y46	Y48B	Y60BHU		MD6
YDS1CAT	1 STR. (.328)		7	.54 [14]	4.56 [116]	9.24 [235]	241	A241 (4)	U241 (4)	---	---	---	---	W-241 (8)	---
YDS25AT	1/0 STR. (.368)		7	.62 [16]	3.57 [91]	7.27 [185]	243 BG	A243 (3)	U243 (3) UBG (5)	---	---	C243 (2)	L243 (2)	W-243 (6) BG (12)	K5/8 - K5/8-1
YDS26AT	2/0 STR. (.414)		7	.70 [18]	4.56 [116]	9.24 [235]	245	A245 (4)	U245 (5)	---	---	C245 (2)	L245 (2)	W-245 (9)	K5/8 - K5/8-1
YDS27AT	3/0 STR. (.464)		7, 19	.77 [20]	3.56 [90]	7.25 [184]	247	A247 (4)	U247 (4)	---	---	C247 (3)	L247 (3)	W-247 (8)	K737
YDS28AT	214 kcmil (.522) 4/0 STR. (.528) 4/0 ACAR 4/3 STR. (.502)		7, 19 4/3 STR	.86 [22]	5.17 [131]	10.47 [266]	249	A249 (6)	U249 (6)	---	---	C249 (3)	L249 (3)	W-249 (12)	K840
YDS29AT	250 kcmil (.574)		19	.92 [23]	3.71 [94]	7.54 [192]	616	A616 (6)	U616 (6)	---	---	---	---	---	---
YDS291AT	266.8 kcmil (.586)		7	.97 [25]	4.25 [108]	8.62 [219]	251	A251 (7)	U251 (7)	---	---	C257 (4)	L251 (4)	---	---
YDS30AT	300 kcmil (.629)		19	1.03 [26]	4.25 [108]	8.62 [219]	322	A322 (7)	U322 (7)	---	---	---	---	---	---
YDS301AE	336.4 kcmil (.666)		19	.99 [25]	4.75 [121]	9.62 [244]	251	A251 (8)	U251 (7)	---	---	C257 (4)	L251 (4)	---	---
YDS301AT	336.4 kcmil (.666) 336.4 kcmil (.668) 336.4 COMPT (.603)		19 37 19	1.06 [27]	4.88 [124]	9.88 [251]	321, 705, 655	A321 (8)	U321 (8) U655 (8) U705 (4)	---	P705 (8)	C321 (4) C605 (4) C705 (4)	L321 (4)	---	K1-1/8-1
YDS311AT	397.5 kcmil (.724)		19	1.19 [30]	6.05 [154]	12.22 [310]	468	---	U468 (10)	---	---	---	---	---	---
YDS321AT	428 kcmil (.755)		19	1.19 [30]	6.25 [159]	12.62 [321]	316	---	U316 (9)	---	---	C316 (3)	L316 (3)	---	---
YDS331AT	477 kcmil (.793) 477 kcmil (.795) 477 COMPT (.722)		19 37 19	1.30 [33]	6.30 [160]	12.73 [323]	317	---	U317 (9)	---	---	C317 (3)	L317 (3)	---	K1-1/8-1 K1-1/4
YDS351AT	556.5 kcmil (.858)		19, 37	1.39 [35]	6.30 [160]	12.73 [323]	318	---	U261 (9)	---	U261	C261 (3)	L261 (3)	---	---
YDS361AT	636 kcmil (.918)		37	1.50 [38]	6.67 [169]	13.47 [342]	469	---	---	S469 (8)	P469 (8)	C469 (4)	L469 (4)	---	---
YDS391AT	795 kcmil (1.026) 800 kcmil (1.031)		37 61, 91	1.67 [42]	6.72 [171]	13.56 [344]	342	---	---	S342 (8)	P342 (8)	C342 (4)	L342 (4)	---	K1-1/2
YDS425ATCG1	927 kcmil (1.108)		37	1.84 [47]	8.38 [213]	17.56 [446]	352 579	---	---	S352 (10) S579 (10)	P352 (10) P579 (10)	C352 (5) C579 (5)	L352 (5) L579 (5)	---	---
YDS28ATG4	3/0 ACAR (.502)		4/3	.86 [22]	5.17 [131]	10.47 [266]	249	A249 (6)	U249 (6)	---	---	C249 (3)	L249 (3)	W-249 (12)	K840

NOTES:

- MATERIAL: ALUMINUM TUBING.
- CAT. NO. PT6515 ADAPTER IS REQUIRED IN Y45 SERIES TOOLS.
- CAT. NO. PUADP-1 ADAPTER IS REQUIRED IN Y46 SERIES TOOLS.
- FOR USE BY CUSTOMERS THAT HAVE THIS HYPRES™. NO NEW Y34A HYPRES™ TOOLS ARE BEING PROCESSED.
- DIMENSIONS IN BRACKETS [] ARE IN MILLIMETERS ROUNDED OFF TO THE NEAREST MILLIMETER, UNLESS OTHERWISE NOTED, AND ARE FOR RERERENCE ONLY.
- BARRELS PARTIALLY FILLED WITH PENETROX™ AND SEALED.
- FLAT SIDED.
- WHEN USING OTHER MANUFACTURER'S TOOLING, CRIMPS MAY OVERLAP OR BE SPACED 1/16" (MAX.) APART.
- FOR FASTER INSTALLATIONS USE BURNDY PATRIOT FAMILY OF BATTERY TOOLS

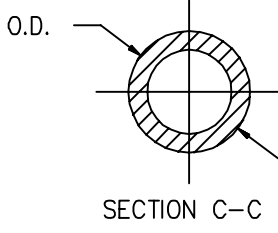
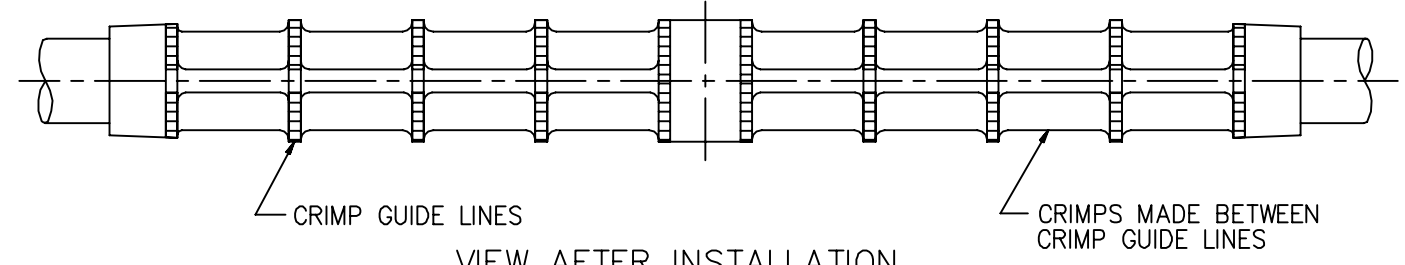
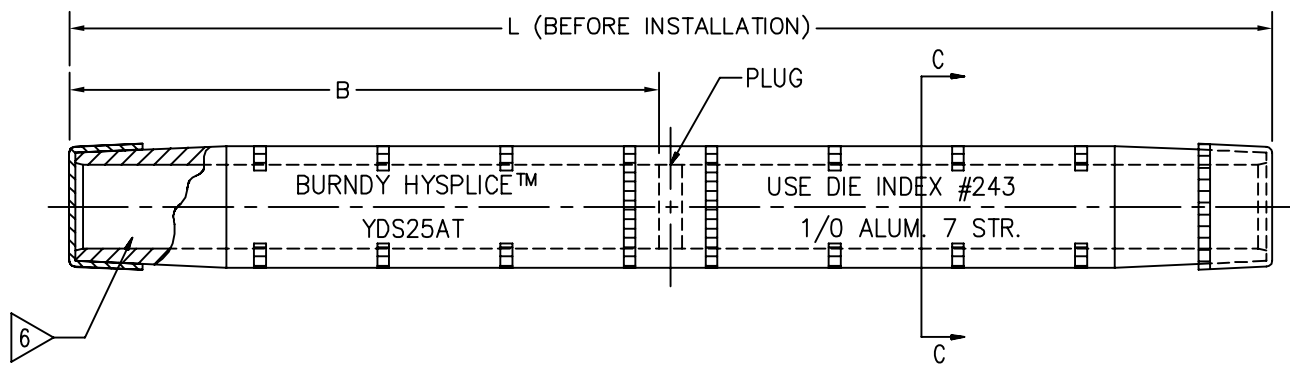

VIEW BEFORE INSTALLATION

VIEW AFTER INSTALLATION

TO ORDER BURNDY® PRODUCTS CALL
UNITED STATES:
1-800-346-4175 (LONDONDERRY, NH)
CANADA:
1-800-361-6975 (QUEBEC)
1-800-387-6487 (ALL OTHER PROVINCES)
FOR PRODUCT INFO: <http://www.burndy.com>

HYSPLICE™ TENSION (ALL AL.)	
ITEM NO: ---	
CAT NO: YDA-AE, YDS-AT, YDS-ATG, YDS-ATG1	
SCALE: N/A	
DRAWN BY: P.D. 10/28/52	
CHECKER: W.C. 10/30/52	
DSN APPVL: K.BRAIN 1/9/2014	
MFG APPVL: --- 1/9/2014	
QC APPVL: K. CHERYL 1/7/2014	
MKT APPVL: H. JEFFERSON 1/9/2014	
PROD FAM: ---	
PROJECT #: ---	SIZE
DOCUMENT TYPE: Sales	D
REL LEVEL: AutoCAD	
DRAWING NO	REV
SD21880-01	D
SHEET 1 OF 1	

SUPERSEDES: SC51612

